



PROJECT		REF		REV	ITEM CODE	
LOCATION		DATE			PAGE	

## SANITARY WARE SPECIFICATION SHEET

Item Descriptions	GROHE (Germany) "Hospita" Chrome plated 1/2" single lever sink pillar tap; nominated flow rate <b>1.8 L/min</b> in WELS <b>Grade 1</b> ; Registration No. TN 20-0004 ; operating force of lever control less than <b>22N</b> ; <b>test report J24280C</b> ; complied with Barrier Free Access 2008
Dimensions	L150 x W150 x H176 mm
Model	30978000
Finish / Material	Chrome Plated
Country of origin	Germany
Manufacturer	GROHE Limited
Supplier	Acme Sanitary Ware Co. Ltd Mr. Eric Wong/ Mr. Don Yuen
Contact Tel/Fax	(852) 2388-7171 / (852) 2710-8012
E-mail	acme@acmesanitary.com.hk
Website	www.acmesanitary.com.hk



### "Hospita" 1/2" single lever sink pillar tap

- red/blue markers
- **GROHE StarLight** chrome finish

Flow Rate Chart  
30978000 + A5.9042.1

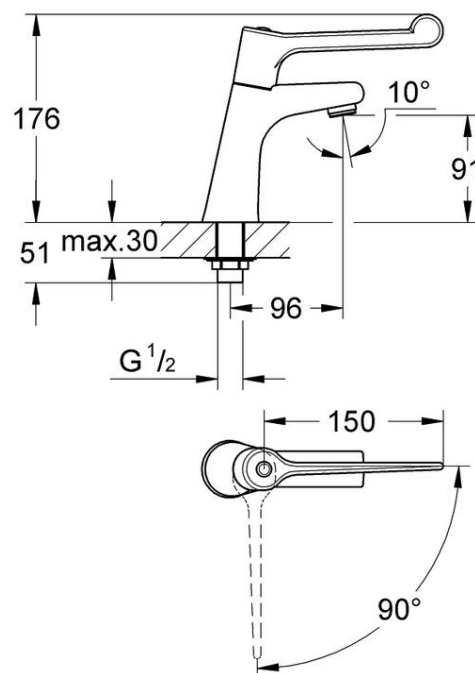
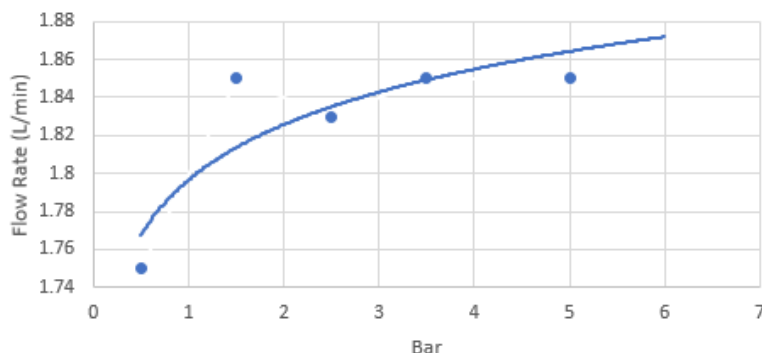

Note:



\* All information of the above is for the reference only. No prior notice is made if any changes.

註冊號碼 (Registration No.):

TN 20-0004



自願參與用水效益標籤計劃 - 水龍頭  
Voluntary Water Efficiency Labelling Scheme - Water Taps



茲證明  
This is to certify that

將下列水龍頭在本計劃內註冊：  
has registered the following water tap under this scheme :

牌 子 / Brand	:	Grohe + Neoperl
型 號 / Model	:	30978000 + A5.9042.1
種 類 / Type	:	Non-mixing
原產地 / Country or Region Origin	:	Portugal (Tap) Germany (Flow Controller)

在用水效益標籤上展示的標誌 <i>Symbolic Presentation on the Water Efficiency Label</i>	:		滴水點 <i>Water droplet(s)</i>
用水效益級別 <i>Water Efficiency Grade</i>	:	1	
耗水量 <i>Water Consumption</i>	:	1.8	公升/分鐘 <i>litres/minute</i>

簽發日期：  
Date of Issue: 28 February 2020



水務署  
Water Supplies Department



水務署署長(張業駒代行)  
for Director of Water Supplies



ies Department

打道七號入境事務大樓 48 樓

Immigration Tower, 7 Gloucester Road, Wan Chai, Hong Kong

本署檔號 : (2) in WSD 3321/19 T/J(811/2019)  
Our ref.  
來函檔號 :  
Your ref.

電話 :  
Tel.  
傳真 : 2824 0578  
Fax.

11 September 2019



**Approval of "GROHE" Pillar Tap  
(General Acceptance No. C20190464)**

Your letter ref. WRC/2104 dated 9 August 2019 refers.

Having considered the test report ref. J24280A issued on 23 July 2019 by Nutek Systems (HK) Ltd., this Authority accepts that the fitting described below complies with, and its use when correctly installed does not contravene, the Waterworks Ordinance and Regulations.

**Name of Manufacturer:** Grohe AG

**Country of Origin:** Portugal

**Brand:** Grohe

**Details of Fitting:** 1/2" Single lever pillar tap

**Model:** 30978000

**Body Markings:** 

**Expiry Date:** 27 May 2024



This Authority hereby permits the use of the above fitting in fresh water plumbing systems subject to full adherence to Waterworks installation requirements.

A condition of this acceptance is that the fitting to be installed shall be replicas of the sample as certified by the testing agent mentioned above and without modifications. This acceptance may be withdrawn at any time if the standard of the fitting installed fails to meet that of the approved sample or if the fitting is found to be unsuitable for use in fresh water plumbing systems.

This acceptance is only applicable to the main body of the fitting, unless otherwise specified.

For the use of the fitting in any project, the General Acceptance Number of this letter must be quoted as a means of identification of acceptance of the fitting by this Authority.

Should you have any enquiries, please contact our Engineer Mr. Terry KUNG at tel. no. 3583 4086.

Yours faithfully,

  
(CHEUNG Yip-kui)

for Director of Water Supplies

Encl.

c.c.     WSD 3321/1/82    ] - without catalogue  
         ME/MC            ] - with soft copy only





# Nutek Systems

Nutek Systems, Limited, Unit 736, Block A, Universal Industrial Centre, 23-25 Shan Mei Street, FO TAN, N.T., HONG KONG  
Tel: +853 2692 0798 info@nuteksystems.com www.nuteksystems.com

## Test Report

TITLE : Testing of Watertap  
OUR REFERENCE : J 24280C  
DESCRIPTION OF SAMPLE<sup>1</sup> : ½" single lever pillar tap  
SAMPLE SUBMITTED BY<sup>1</sup> :

MANUFACTURER<sup>1</sup> : Grohe AG  
BRAND<sup>1</sup> : GROHE  
COUNTRY OF ORIGIN<sup>1</sup> : Portugal  
MODEL<sup>1</sup> : 30978000  
BODY MARKINGS : /  
PERIOD OF TESTS : 23 May, 2019

<sup>1</sup> – Information provided by client

**RESULTS:-** (apply only to the sample tested)

### SUMMARY OF RESULTS

Test	Remark
1 Operating force test	C

### 1. OPERATING FORCE TEST

Variable		Measured	Required	Remark
Operating Force (N)	1st	2.2	≤ 22 for Hong Kong ≤ 23 for Macau	C
	2nd	2.0		C
	3rd	2.0		C
Overall result				C

Remark: The sample was tested under 4 bar static pressure.

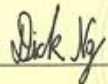
Date: 06 Jun., 2019 Authorized signature: 

NG DICK TIK LUN  
(Test Engineer)

Nutek Systems is a testing agency,  
accepted by the Water Supplies  
Department, for testing water supply  
fittings.